

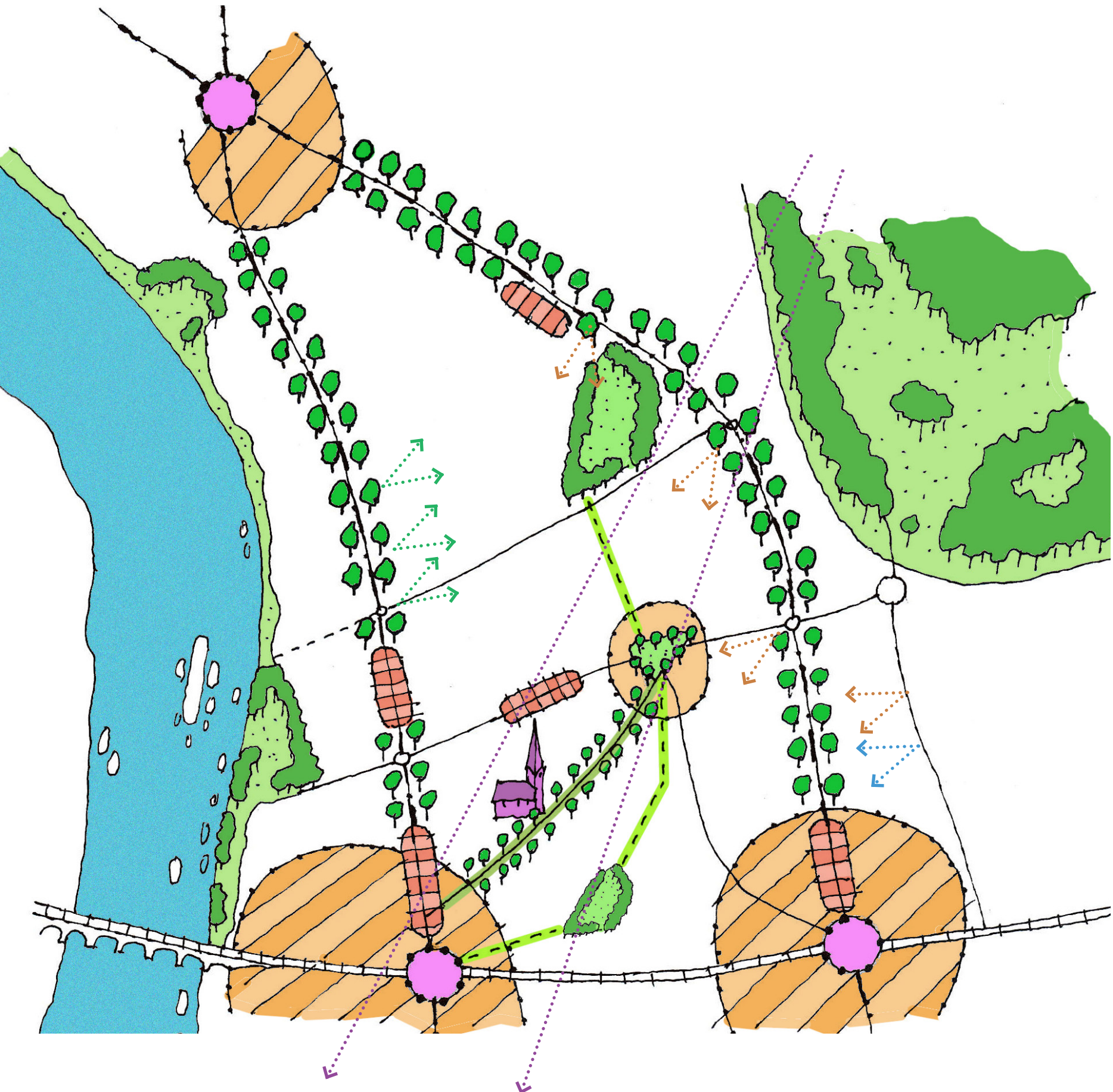

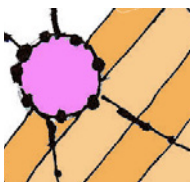



Our neighbourhood moving forward:

Encouraging positive regeneration that will enhance our neighbourhood

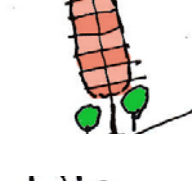
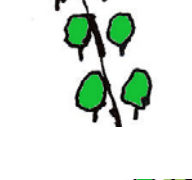
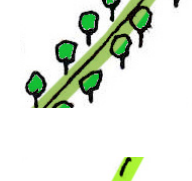
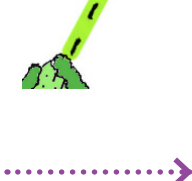
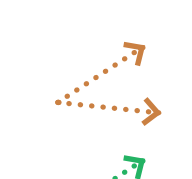

Our Vision includes:

-  **Enhancement of existing gateways:**
 - environmental improvements
 - regeneration with mixed use residential led development featuring employment and culture.
-  **Neighbourhood 'heart'**
At the junction of Kings Road and Acre Road, featuring a Village Green
-  **Enhanced Business Parades**
Environmental improvements including paving, furniture, signage and planting
-  **Environmental improvements to the Primary Roads**
Enhanced cycle and pedestrian routes to encourage family cycling
-  **Green secondary routes eg Acre Road**
Tree planting along verges and improvements to junctions that are presently road dominated
-  **New green corridors**
Linking parks and open spaces
-  **Protection of Existing Strategic View**
(from Thatched Lodge to Kingston Town Hall)
-  **Protection of Views to St Luke's Church landmark**
-  **Protection of Views to Richmond Park**
-  **Protection of Views to the River Thames**

Our neighbourhood moving forward:

Enhancing connectivity for pedestrians and cyclists

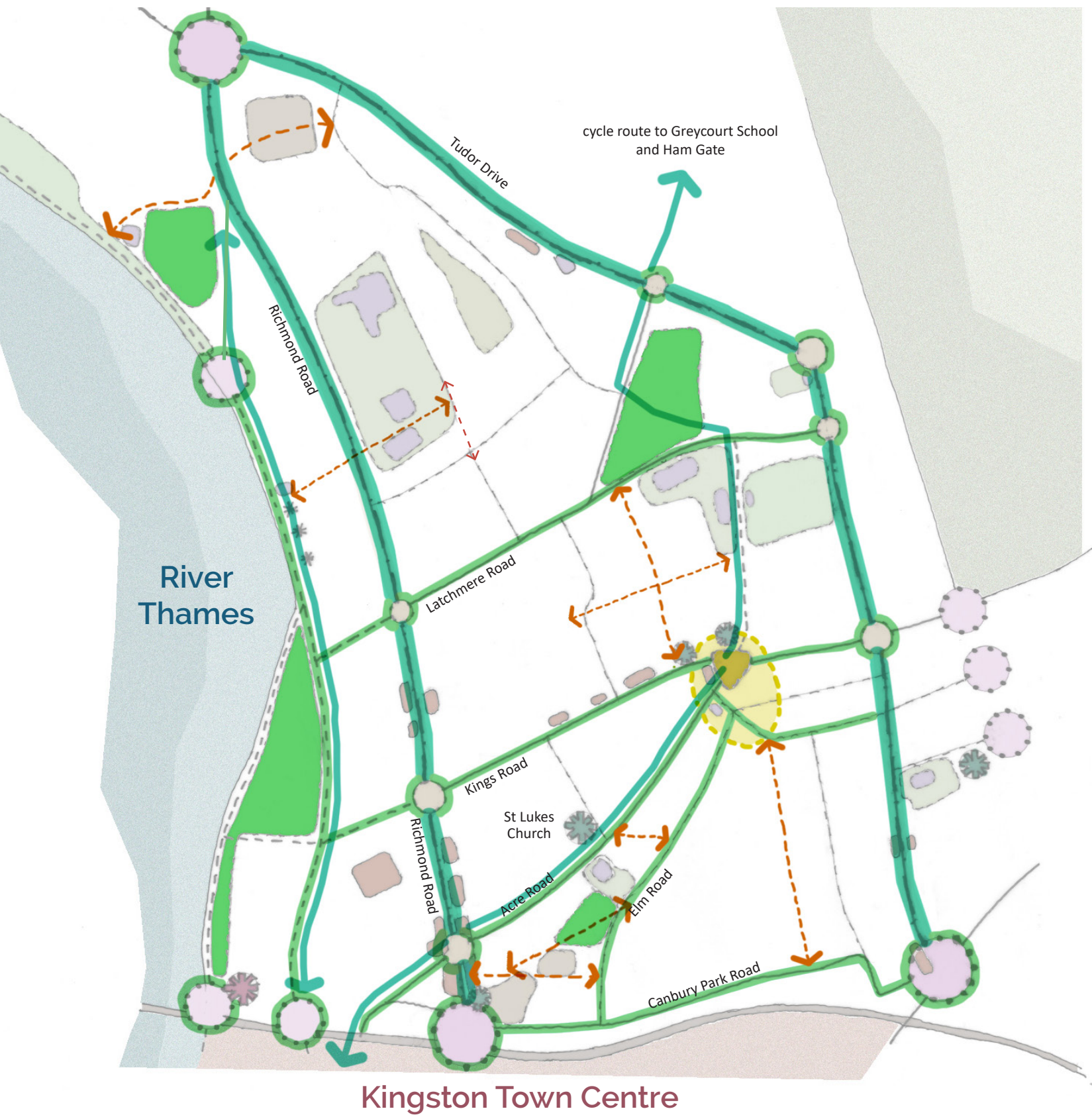

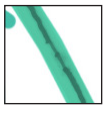
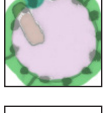
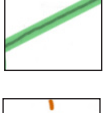
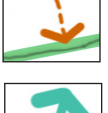
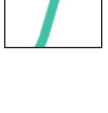
-  Primary roads enhanced with cycle and pedestrian environments
-  Gateways and junctions improved with signage and pedestrian/cycle crossings
-  Secondary roads and shopping parades enhanced with improved pedestrian realms including SUDS and green connectivity
-  Identify long term enhanced pedestrian connectivity through the neighbourhood.
-  Proposed new designated family cycle route

Creating a neighbourhood infrastructure that is green and pedestrian/cycle friendly.

A safe and attractive place for all ages to walk and cycle in which residents and visitors drive through with care and respect.

A townscape with better 'wider connectivity' to Richmond Park, the River Thames and Kingston town centre and 'local connectivity' to schools and open spaces.

